



Roosevelt Elementary

Proposal 1

Security and Safety

- Additional Security Cameras
- Replace Doors
- Upgrade Emergency & Exit Lighting
- Upgrade P.A. System
- Upgrade Fire Alarm System

Learning Environments

- New Flexible Instructional Space
- Replace Obsolete Furniture
- Renovate Media Center
- Renovate and Enlarge Kindergarten Classrooms, with Bathrooms
- Replace Classroom Casework
- Upgrade Heating & Ventilation
- Upgrade Technology

Infrastructure

- Replace Ceilings
- Replace Flooring
- Replace Deteriorating Bathrooms
- Replace Lockers

Energy and Operational Efficiency

- Replace Windows

Proposal 2

Security and Safety

- Replace Deteriorating Parking Lots, Asphalt Play Areas, and Sidewalks
- Replace Parking Lot Lighting

Learning Environments

- Improve Climate Control with New Air Conditioning

Infrastructure

- Replace Flagpole

Energy and Operational Efficiency

- New Elevator to Second Floor
- New Wheelchair Lift to Stage
- Replace Boiler



BUILDING TOMORROW, TODAY Port Huron Schools

Bond 2016 Major Features

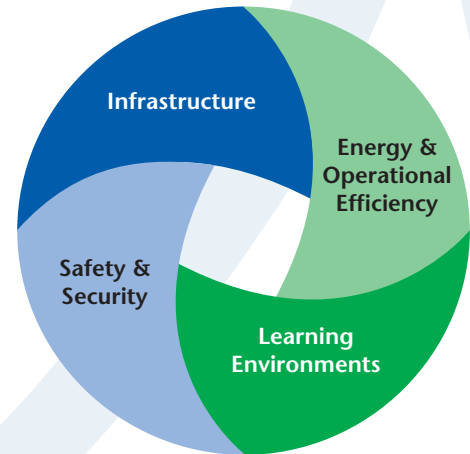

Bond 2016 is a comprehensive facilities upgrade and construction program that touches every building across the district. Key highlights:

- Learning Environment-focused upgrades to meet 21st century educational and technology requirements;
- Improvements to address the aging infrastructure of all buildings;
- Safety and Security upgrades that build upon security initiatives already in place;
- Energy initiatives to improve the operational efficiency of buildings and reduce operational expenses.

Extensive renovations will occur at all District buildings. Other features include:

- New Early Childhood Center located on the McKinley/ Crull campus, allowing consolidation of current programming. This provides additional space in our elementary buildings for expanded kindergarten classrooms, dedicated art and music space, etc.
- Replacement Elementary School for the current Kimball Elementary School.
- New additions at elementary and high schools and renovations at our middle schools to provide flexible and collaborative learning environments.

For More Information

Supt. Jamie Cain | 810.984.3101x4019
www.phsbtt.us | facebook.com/porthuronschools | @PHSchools



LEGEND

- ADDITION
- ASSESSMENT UPDATES
- HEAVY REMODELING
- LIGHT REMODELING
- CIRCULATION



SECOND LEVEL COMPOSITE PLAN

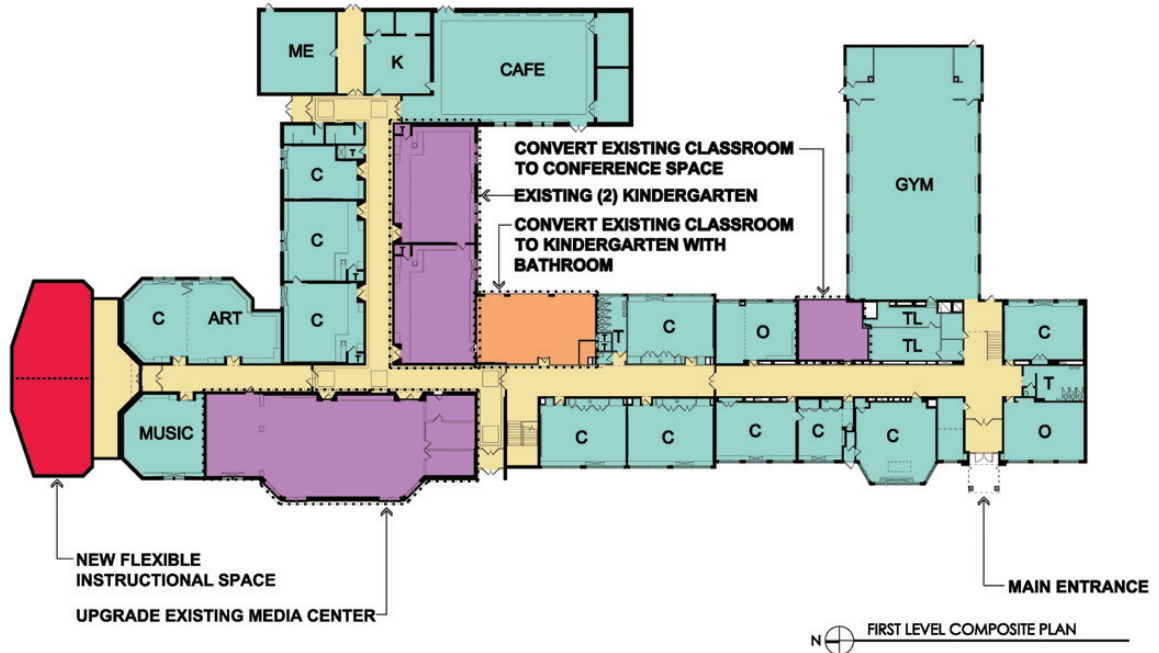

FIRST LEVEL COMPOSITE PLAN

Conceptual Draft

Anticipated Benefits of Bond 2016

- * Upgrades learning environments and technology to respond to the district's vision of 21st Century teaching and learning
- * Strengthens security in our schools
- * Preserves District facilities; which can protect our property values
- * Reduces pressure on general fund by using "bond" dollars for building & technology upgrades

Current Millage Rate Comparison Port Huron Schools and County Districts

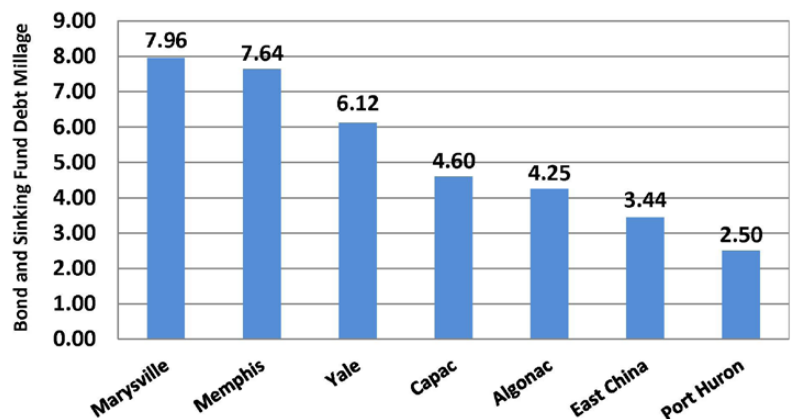

Port Huron Schools currently has the lowest millage rate, and if voters approve the proposals, the millage would be at 6.05 mills - the midpoint of county districts.

Register to Vote by
Monday,
April 4, 2016

ELECTION DAY
Tuesday,
May 3, 2016