



**Central Middle School**



**BUILDING TOMORROW, TODAY**  
Port Huron Schools

**Proposal 1**

**Security and Safety**

- New Secure Welcome Center
- Additional Security Cameras
- Replace Doors
- Upgrade Emergency & Exit Lighting
- Upgrade P.A. & Fire Alarm Systems

**Learning Environments**

- New S.T.E.A.M. Lab
- Replace Obsolete Furniture
- Renovate Science Labs & Media Center
- Reconfigure Classrooms for Grade-Level Collaboration
- Replace Classroom Casework
- New Band Equipment
- Upgrade Heating & Ventilation
- Upgrade Technology

**Infrastructure**

- Replace Ceilings & Flooring
- Replace Deteriorating Bathrooms
- Replace Lockers

**Energy and Operational Efficiency**

- Replace Windows & Lighting

**Proposal 2**

**Security and Safety**

- Replace Deteriorating Sidewalks
- Extend Sidewalks

**Learning Environments**

- Improve Climate Control with New Air Conditioning

**Infrastructure**

- Replace P.E. Lockers & Drinking Fountains
- Replace Deteriorating Exterior Metal Panels

**Energy and Operational Efficiency**

- New Elevator to Second Floor
- New Wheelchair Lift to Stage
- Replace Boiler
- Replace Roof Top Mechanical Units

**Bond 2016 Major Features**

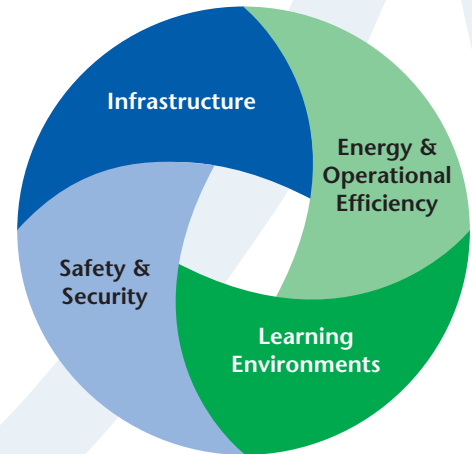

Bond 2016 is a comprehensive facilities upgrade and construction program that touches every building across the district. Key highlights:

- Learning Environment-focused upgrades to meet 21st century educational and technology requirements;
- Improvements to address the aging infrastructure of all buildings;
- Safety and Security upgrades that build upon security initiatives already in place;
- Energy initiatives to improve the operational efficiency of buildings and reduce operational expenses.

Extensive renovations will occur at all District buildings. Other features include:

- New Early Childhood Center located on the McKinley/ Crull campus, allowing consolidation of current programming. This provides additional space in our elementary buildings for expanded kindergarten classrooms, dedicated art and music space, etc.
- Replacement Elementary School for the current Kimball Elementary School.
- New additions at elementary and high schools and renovations at our middle schools to provide flexible and collaborative learning environments.

**For More Information**

Supt. Jamie Cain | 810.984.3101x4019  
www.phsbtt.us | facebook.com/porthuronschools | @PHSchools



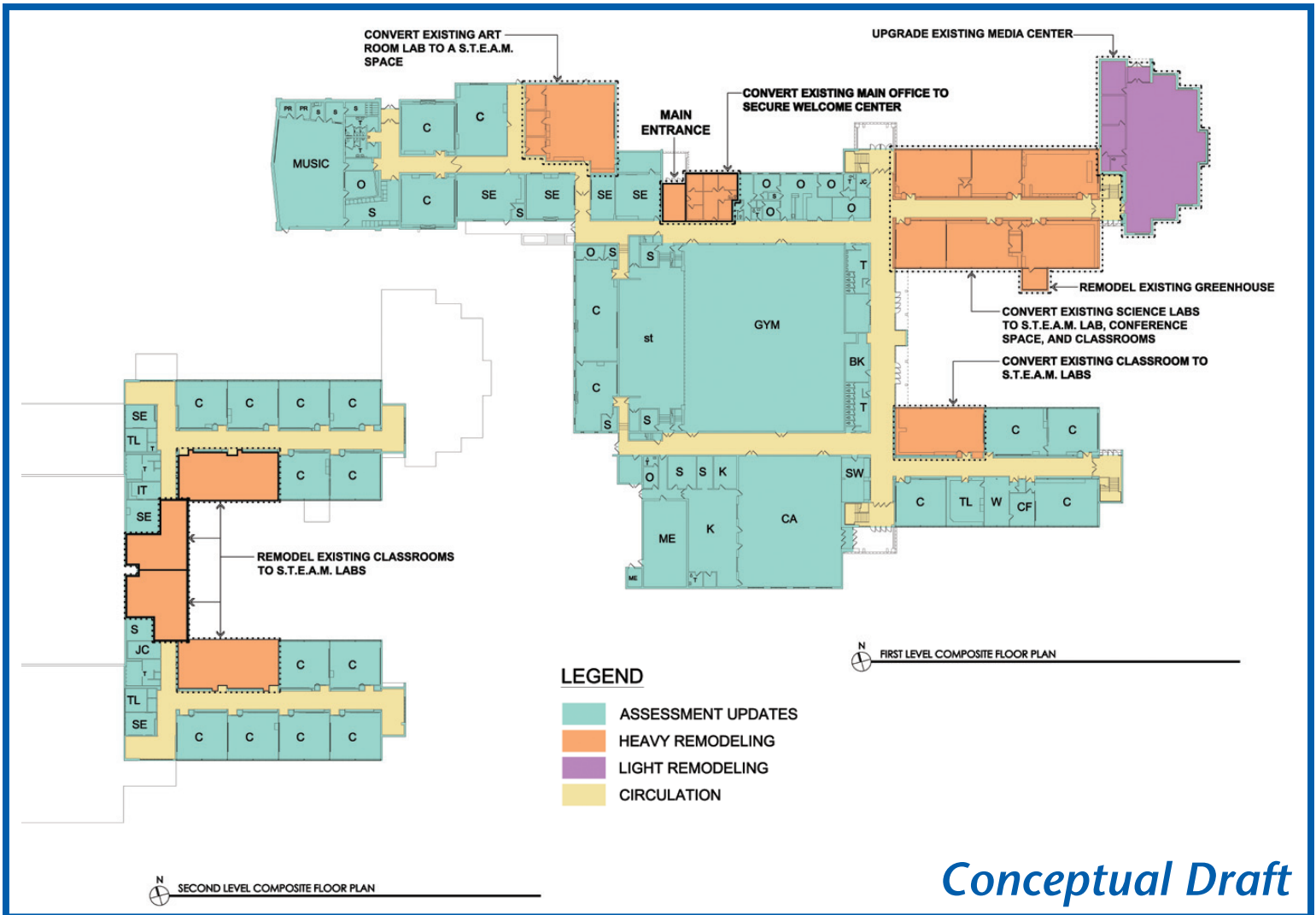

*Conceptual Draft*

## Anticipated Benefits of Bond 2016

- \* Upgrades learning environments and technology to respond to the district's vision of 21st Century teaching and learning
- \* Strengthens security in our schools
- \* Preserves District facilities; which can protect our property values
- \* Reduces pressure on general fund by using "bond" dollars for building & technology upgrades

## Current Millage Rate Comparison Port Huron Schools and County Districts

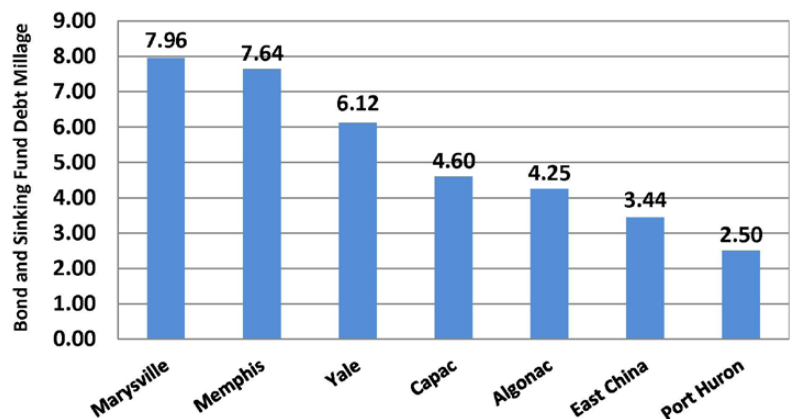

*Port Huron Schools currently has the lowest millage rate, and if voters approve the proposals, the millage would be at 6.05 mills - the midpoint of county districts.*

Register to Vote by  
Monday,  
April 4, 2016

**ELECTION DAY**  
Tuesday,  
May 3, 2016